

INSTALLATION INSTRUCTIONS

801-317-8802 | www.support.pdk.io

1. Take Lock Apart

1. Turn the handle on the inside lever 45°
2. Insert the lever pick into the hole.
3. Pull off the handle, mounting plate, and eschutcheon.
4. Check the handing of the lock. If you have to switch the handing, refer to the Optional step at the end of these instructions.

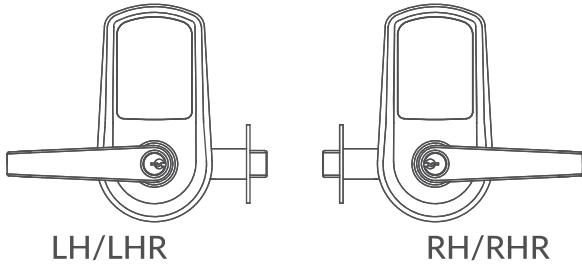

2. Prepare Door & Install Latch

1. Prepare the door according to the template.
2. Install the latch with the radius toward the door frame.
3. Secure with two combo screws.

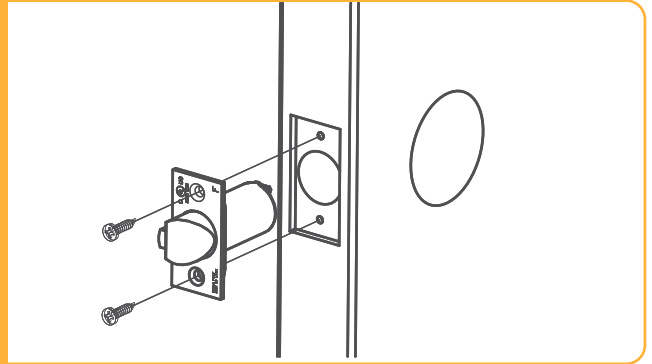

3. Install Outside Trim

1. Install the escutcheon/chassis assembly from outside of the door, while feeding wires through the chassis hole in the door.
2. Verify that the latch is properly slotted within the chassis. Incorrect alignment will result in the lock getting stuck in the extended position.
3. Verify that the wire is secured on the chassis channel under tape.

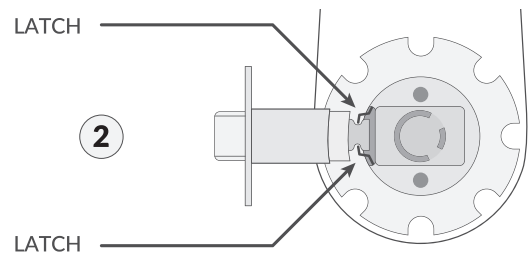
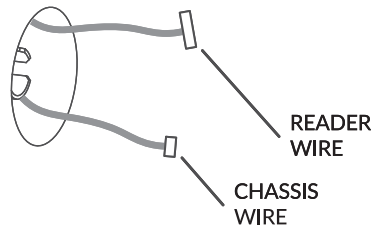
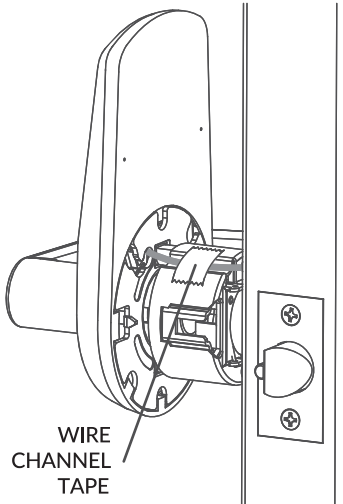

4. Install Inside Mounting Plate

Install the inside mounting plate and secure it with two flat head screws.

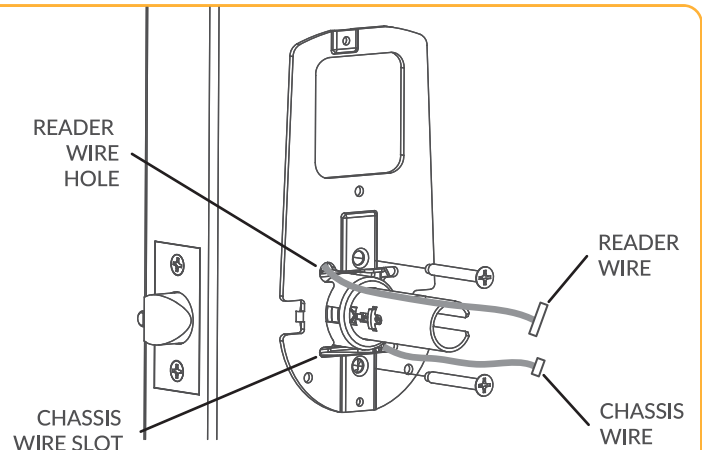

INSTALLATION INSTRUCTIONS

5. Connect Reader And Install Inside Trim

1. Plug the reader wire and chassis wire into sockets on the control board on the back of the escutcheon.
2. Install the escutcheon onto the door.
3. Secure the escutcheon with two short pan head screws.
4. Install batteries and the battery cover with a long pan head screw.
5. Install the lever ring and inside lever. Push until the lever retaining clip clicks into place.

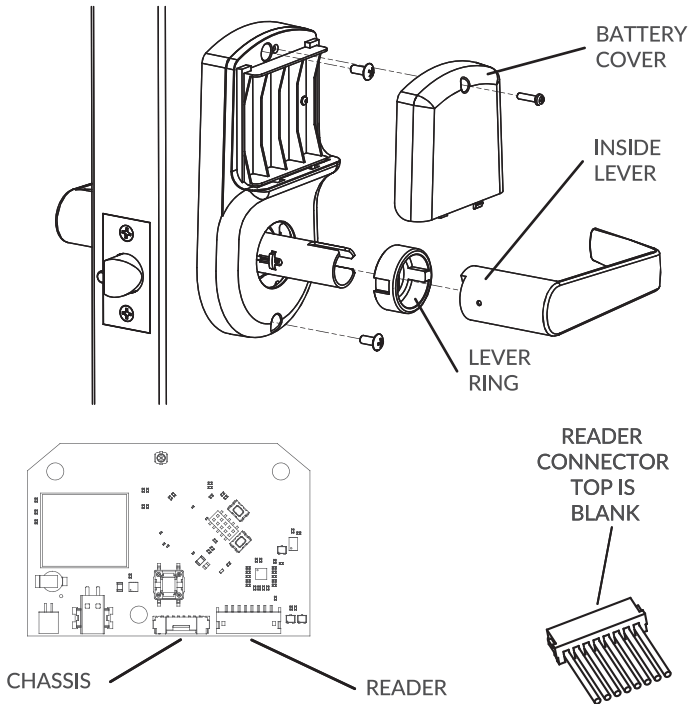

Optional: Adjust Handing of the Lock

1. Remove the outside lever.
Standard Cylinder: Use the supplied pick in the hole on the front of the lever. The lever cannot be removed with a pick until the key is inserted and turned 45 degrees.
Interchangeable Core: Remove the core from the outside lever, then pull back the lever clip from inside.
2. Remove the tape holding the wire to the chassis.
3. Pull the chassis out of the escutcheon and rotate the chassis ½ turn (180°) maximum.
4. Replace the chassis and attach tape.
5. Re-install the lever.
Standard Cylinder: Rotate key while installing.
Interchangeable Core: Insert core.

