

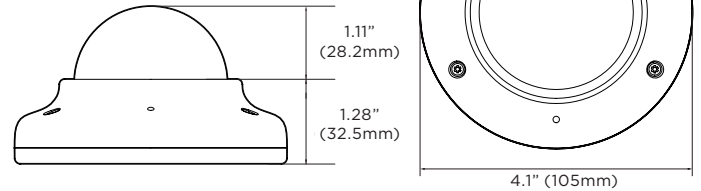

Dimensions

unit: Inch (mm)



Specifications

IMAGE	
Image sensor	2.1MP/1080p 1/2.8" CMOS
Total pixels	1945 (H) X 1109 (V)
Minimum scene illumination	0.05 lux (color) (DWC-MV72Wi28ATW) 0.09 lux (color) (DWC-MV72Wi4ATW) 0.0 lux (B/W)
LENS	
Focal length	2.8mm, F2.0 (DWC-MV72Wi28ATW) 4.0mm, F2.6 (DWC-MV72Wi4ATW)
Lens type	Fixed lens
Field of view (FoV)	115° (DWC-MV72Wi28ATW) 86° (DWC-MV72Wi4ATW)
IR distance	80ft range
I/O	
Audio in / out	1 (mic)/0
Audio compression	G.711
Alarm in / out	1/1
OPERATIONAL	
Shutter mode	Auto, manual, anti-flicker, slow shutter
Shutter speed	1/15 - 1/32000
Slow shutter	1/2, 1/3, 1/5, 1/6, 1/7.5, 1/10
Auto gain control	Auto
Day and night	Auto, day (color), night (B/W)
Smart DNR™ 3D Digital Noise Reduction	3D-DNR
Wide Dynamic Range (WDR) & dB	True WDR, 120dB
Privacy zones	16 programmable privacy masks
Mirror and flip	Yes
Alarm notifications	Notifications via e-mail notifications, FTP and SD card recording
Memory slot	Micro SD / SDHC / SDXC (card not included)
NETWORK	
LAN	RJ45 (10/100Base-T)
Video compression type	H.265, H.264, MJPEG
Resolution	H.265: 2.1MP/1080p, 720p, VGA, D1, CIF H.264: 2.1MP/1080p, 720p, VGA, D1, CIF MJPEG: 1280x720, 800x600, VGA, 768x432, D1, CIF
Frame rate	Up to 30fps at all resolutions
Video bitrate	100Kbps - 10Mbps, multi-rate for preview and recording
Bitrate control	Multi streaming CBR/VBR at H.264, H.265 (controllable frame rate and bandwidth)
Streaming capability	Dual-stream at different rates and resolutions
IP	IPv4, IPv6
Protocol	TCP/IP, UDP, AutoIP, RTP (UDP/TCP), RTSP, NTP, HTTP, HTTPS, SSL, DNS, DDNS, DHCP, FTP, SMTP, ICMP, SNMPv1/v2/v3 (MIB-2), ONVIF
Security	HTTPS (SSL), IP filtering, 802.1x, digest authentication (ID/PW)
ONVIF conformance	Yes
Web viewer	OS: Windows®, Mac® OS, Linux® Browser: Internet Explorer®, Google Chrome®, Mozilla Firefox®, Safari®
Video management software	DW Spectrum® IPVMS
ENVIRONMENTAL	
Operating temperature	-4°F - 122°F (-20°C - 50°C)
Operating humidity	10-90% (non-condensing)
IK rating	IK10 impact resistant
IP rating	IP67-rated
Other certifications	CE, FCC, RoHS
ELECTRICAL	
Power requirement	DC 12V, PoE IEEE 802.3af Class 2. (Adapter not included)
Power consumption	DC12V: max 3.7W PoE: max 5.5W
MECHANICAL	
Material	Aluminum vandal housing, polycarbonate dome
Dimensions	4.13" x 2.4" (105 x 61mm)
Weight	0.79 lbs (0.36kg)
Warranty	5 year warranty

Summary

This MEGApix® IP camera is TAA/NDA compliant and provides 2.1MP/1080p resolution at real-time 30fps and the convenience of audio input through the built-in microphone. It includes 2.8 and 4.0mm fixed lens options, simultaneous H.265/H.264/MJPEG codec support and Star-Light Plus™ color in near-total darkness technology for quality video in any lighting condition, all in an IP67-rated, IK-10 impact-resistant ultra low-profile vandal dome housing. All MEGApix® cameras are ONVIF conformant, assuring their successful integration with any open platform solution on the market.

Features

- 2.1MP/1080p 1/2.8" image sensor at real-time 30fps
- Star-Light Plus™ color in near-total darkness technology
- 2.8mm fixed lens (DWC-MV72Wi28ATW)
- 4.0mm fixed lens (DWC-MV72Wi4ATW)
- True Wide Dynamic Range (WDR)
- Triple codecs (H.265, H.264, MJPEG) with simultaneous streaming
- 80' Smart IR™ with intelligent camera sync
- Audio input through built-in microphone
- Ultra low-profile vandal dome camera
- Smart DNR™ 3D digital noise reduction
- True day/night mechanical IR cut filter
- Programmable privacy zones
- Auto gain control (AGC)
- Auto white balance (AWB)
- Motion detection
- Micro SD/SDHC/SDXC class 10 card slot (card not included)
- Web server built-in
- PoE class 2 and DC12V
- TAA / NDA compliant
- IP67 dust-tight and water-proof to 3 feet
- IK 10-rated impact-resistant
- 5 year warranty



Accessories (optional)



DWC-V7WMW
Wall mount
bracket

DWC-V7CMW
Ceiling mount
bracket

DWC-V7JUNCW
Junction box

DWC-V7DECO
5x decorative rings