

STROBE INSTALLATION FOR ELK-1RT OR ELK-150RT
STAINLESS STEEL BOX
ALSO FITS ELK-1EL, ELK-1TB & ELK-1BOX

- A) IF YOUR ELK STAINLESS STEEL BOX IS ALREADY MOUNTED, REMOVE THE FRONT COVER. (IT IS NOT NECESSARY TO REMOVE THE SPEAKER.)

1

IF THIS IS A NEW SIREN BOX INSTALLATION, MOUNT THE STAINLESS STEEL BACKPLATE AND SPEAKER/SIREN ACCORDING TO INSTRUCTIONS PROVIDED WITH THAT UNIT.

- B) HANG THE STROBE UNIT ON THE LOWER FLANGE OF THE BACKPLATE BY SLIDING THE CLEAR PLASTIC WIRING PROTECTOR INTO THE LEFT (OUTER) SLOT OF THE BACKPLATE'S LOWER FLANGE. NOTE THAT THE END WITH THE LOOSE WIRES IS TOWARD YOU AND "UP". INSURE THAT THE WIRE SLIDE HAS MOVED ALL THE WAY BACK TO THE WALL.
- C) CONNECT THE RED (12V+) AND BLACK (-) WIRES FROM THE STROBE TO A NON-PULSED "ALARM" OUTPUT OR "VIOLATION" OUTPUT. (MOST PULSED OUTPUTS WILL ALSO OPERATE THE STROBE, BUT THE FLASH RATE WILL BE SLIGHTLY ERRATIC.)

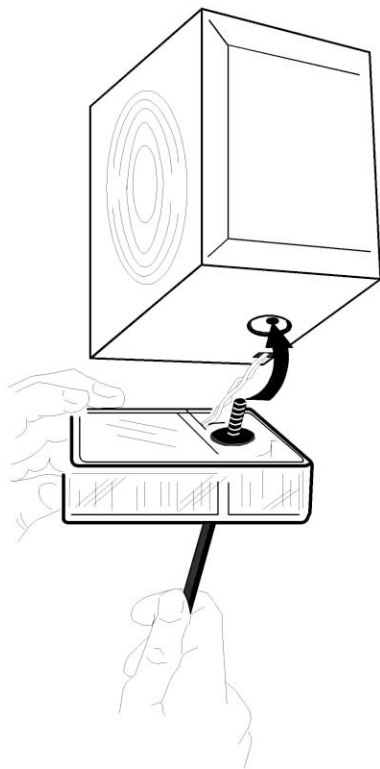
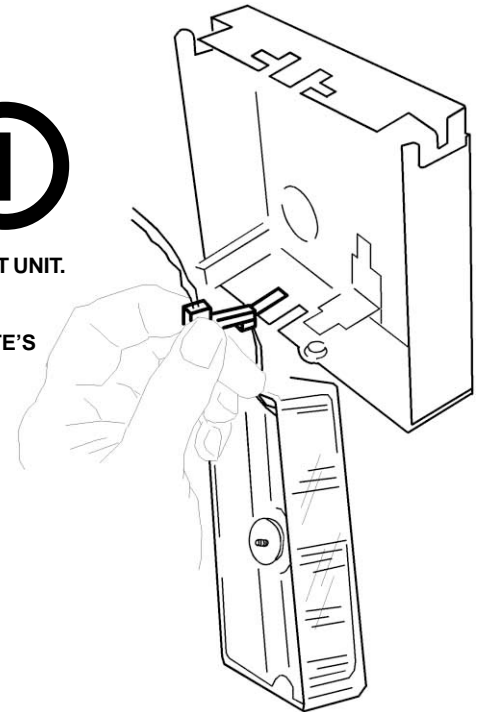

2

- A) WITH THE STROBE UNIT DANGLING BY IT'S WIRES, REPLACE THE FRONT COVER BUT DISCARD THE 1/4-20 HEX HEAD SCREW THAT IS NORMALLY USED TO HOLD THE COVER IN PLACE.
- B) USE A 3/16 HEX (ALLEN) WRENCH TO ENGAGE THE HEX SOCKET SCREW SUPPLIED WITH THE STROBE UNIT (DO NOT REMOVE THE RETAINING WASHER).
- C) PRESS UPWARD ON THE STROBE AND FRONT COVER TO ALLOW ENGAGEMENT OF THE SCREW. INSURE THAT ANY SURPLUS WIRE IS WITHIN THE STROBE CAVITY AND NOT PINCHED BETWEEN THE STROBE AND FRONT COVER.

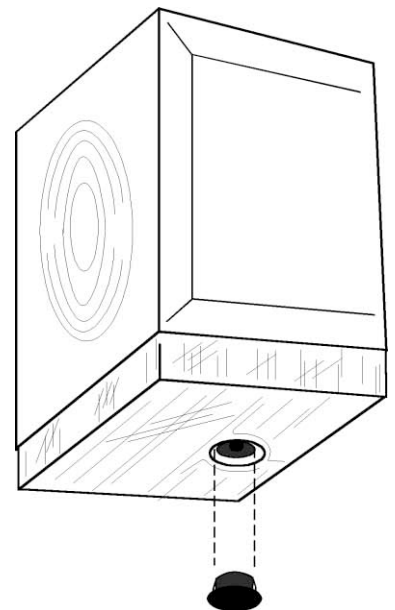

- A) INSTALL THE SUPPLIED BLACK PLUG-A-HOLE BY SIMPLY SNAPPING INTO THE HOLE.

3

SPECIFICATIONS

1. OPERATING VOLTAGE: 12 Volts D.C.
2. CURRENT DRAIN: APPROX. 210ma.
3. FLASH RATE: APPROX. 1 FLASH/SEC.
4. Strobe Not Designed for Continuous Duty Applications.

LIFETIME LIMITED WARRANTY

Elk Products, Inc. ("Manufacturer") warrants to the original purchaser (the "Customer") that the products it manufactures ("Product") shall be free from defects in material and workmanship at time of shipment. Manufacturer's obligations under this Limited Warranty shall be limited to repairing or replacing, at its option, free of charge, any product returned to Manufacturer freight prepaid. Manufacturer shall have no obligation under this Limited Warranty or otherwise if (1) the Product has been damaged by negligence, accident, mishandling, lightning or flood, or other Acts of God, (2) the Product has not been operated in accordance with its operating instructions, (3) the Product has been altered or repaired by anyone outside Manufacturer's authorized facilities (4) adaptations or accessories have been made or attached to the Product which, in Manufacturer's sole determination, have adversely affected its performance, safety or reliability. Products such as batteries and fused transformers have their own warranties, and are not included in this Limited Warranty. If a Product should malfunction or fail, contact Manufacturer or one of its authorized distributors for a Return Authorization (RA) number. Returned Products must include a complete description of the problem, along with the RA number clearly marked on outside of the package. Manufacturer will not be responsible for any unnecessary items included with any returned Product. THIS WARRANTY IS THE EXCLUSIVE WARRANTY FOR ANY PRODUCT. MANUFACTURER SPECIFICALLY DISCLAIMS ANY AND ALL OTHER WARRANTIES OF ANY KIND, EXPRESS OR IMPLIED, INCLUDING ANY WARRANTIES OF FITNESS FOR A PARTICULAR PURPOSE OR OF MERCHANTABILITY. MANUFACTURER SHALL NOT BE LIABLE IN TORT, INCLUDING NEGLIGENCE OR STRICT LIABILITY, AND SHALL HAVE NO LIABILITY AT ALL FOR INJURY TO PERSONS OR PROPERTY. MANUFACTURER'S LIABILITY FOR FAILURE TO FULFILL ITS OBLIGATION UNDER THIS LIMITED WARRANTY OR ANY OTHER LIABILITY IN CONNECTION WITH A PRODUCT SHALL BE LIMITED TO THE AMOUNT OF THE PURCHASE PRICE RECEIVED BY MANUFACTURER FOR THE PRODUCT. THE REMEDIES STATED IN THIS LIMITED WARRANTY ARE THE CUSTOMER'S EXCLUSIVE REMEDIES AGAINST MANUFACTURER REGARDING ANY PRODUCT. UNDER NO CIRCUMSTANCES SHALL MANUFACTURER BE LIABLE FOR ANY INDIRECT, INCIDENTAL, SPECIAL OR CONSEQUENTIAL DAMAGES, INCLUDING LOST PROFITS AND REVENUES, INCONVENIENCE OR INTERRUPTIONS IN OPERATIONS, OR ANY OTHER COMMERCIAL OR ECONOMIC LOSSES OF ANY KIND. THESE LIMITATIONS AND DISCLAIMERS ARE NOT MADE BY MANUFACTURER WHERE PROHIBITED BY LAW. SOME STATES PROHIBIT LIMITATIONS OF WARRANTIES AND THE CUSTOMER MAY HAVE ADDITIONAL RIGHTS IN THOSE STATES.

ELK PRODUCTS, INC.

PO Box 100 • Hildebran, NC 28637 • 828-397-4200 • 828-397-4415 FAX
http://www.elkproducts.com • email: info@elkproducts.com