







# TruVision Stainless Steel Box Camera Outdoor Housing Installation Guide

P/N 1073433-EN • REV B • ISS 23MAR18



<b>Copyright</b>	© 2018 United Technologies Corporation, Interlogix is part of UTC Climate, Controls & Security, a unit of United Technologies Corporation. All rights reserved.
<b>Trademarks and patents</b>	Trade names used in this document may be trademarks or registered trademarks of the manufacturers or vendors of the respective products.
<b>Manufacturer</b>	Interlogix 2955 Red Hill Avenue, Costa Mesa, CA 92626-5923, USA Authorized EU manufacturing representative: UTC Fire & Security B.V. Kelvinstraat 7, 6003 DH Weert, The Netherlands
<b>Certification</b>	  
<b>FCC compliance</b>	<b>Class A:</b> This equipment has been tested and found to comply with the limits for a Class A digital device, pursuant to part 15 of the FCC Rules. These limits are designed to provide reasonable protection against harmful interference when the equipment is operated in a commercial environment. This equipment generates, uses, and can radiate radio frequency energy and, if not installed and used in accordance with the instruction manual, may cause harmful interference to radio communications. Operation of this equipment in a residential area is likely to cause harmful interference in which case the user will be required to correct the interference at his own expense.
<b>FCC conditions</b>	This device complies with Part 15 of the FCC Rules. Operation is subject to the following two conditions: (1) This device may not cause harmful interference. (2) This Device must accept any interference received, including interference that may cause undesired operation.
<b>ACMA compliance</b>	<b>Notice!</b> This is a Class A product. In a domestic environment this product may cause radio interference in which case the user may be required to take adequate measures.
<b>Canada</b>	This Class A digital apparatus complies with CAN ICES-003 (A)/NMB-3 (A). Cet appareil numérique de la classe A est conforme à la norme CAN ICES-003 (A)/NMB-3 (A).
<b>European Union directives</b>	This product and - if applicable - the supplied accessories too are marked with "CE" and comply therefore with the applicable harmonized European standards listed under the EMC Directive 2014/30/EU, the RoHS Directive 2011/65/EU.
 	<b>2012/19/EU (WEEE directive):</b> Products marked with this symbol cannot be disposed of as unsorted municipal waste in the European Union. For proper recycling, return this product to your local supplier upon the purchase of equivalent new equipment, or dispose of it at designated collection points. For more information see: <a href="http://www.recyclethis.info">www.recyclethis.info</a> .

**Product  
warnings  
and  
disclaimers**

THESE PRODUCTS ARE INTENDED FOR SALE TO AND INSTALLATION BY QUALIFIED PROFESSIONALS. UTC FIRE & SECURITY CANNOT PROVIDE ANY ASSURANCE THAT ANY PERSON OR ENTITY BUYING ITS PRODUCTS, INCLUDING ANY "AUTHORIZED DEALER" OR "AUTHORIZED RESELLER", IS PROPERLY TRAINED OR EXPERIENCED TO CORRECTLY INSTALL FIRE AND SECURITY RELATED PRODUCTS.

For more information on warranty disclaimers and product safety information, please check [www.firesecurityproducts.com/policy/product-warning/](http://www.firesecurityproducts.com/policy/product-warning/) or scan the QR code:



**Contact  
information  
and manuals**

For contact information go to: [www.interlogix.com](http://www.interlogix.com) or [www.firesecurityproducts.com](http://www.firesecurityproducts.com)

To get translations for this and other product manuals go to: [www.firesecurityproducts.com](http://www.firesecurityproducts.com)

# Content

## **Introduction 6**

Product overview 6

## **Installation 6**

Installation environment 6

Package contents 7

SS box camera housing description 9

IR illuminators 9

Alarm input and output connections 10

SD memory card installation 10

Mounting the SS box camera housing 13

Mounting the TVJ-JBS junction box 13

Using the camera with an Interlogix NVR or Hybrid DVR or  
another system 14

Using the camera with TruVision Navigator 14

**Access the camera over the internet 14**

**Specifications 17**

**Pin definitions 18**

# Introduction

## Product overview

This is the installation guide for the TruVision Stainless Steel (SS) box camera housing models:

- TVB-5801 (stainless steel outdoor box camera housing with 2 MPX camera, 3.8-16 mm lens, 50 m IR, fan, heater)
- TVB-5802 (stainless steel outdoor box camera housing with 2 MPX camera, 11-40 mm lens, 100 m IR, fan, heater)

## Installation

This section provides information on how to install the housing.

### Installation environment

When installing your product, consider these factors:

- **Electrical:** Install electrical wiring carefully. It should be done by qualified service personnel. Always use a proper PoE switch or a 24 VAC UL listed Class 2 or CE certified power supply to power the camera. Do not overload the power cord or adapter.
- **Ventilation:** Ensure that the location planned for the installation of the camera is well ventilated.
- **Temperature:** Do not operate the camera beyond the specified temperature, humidity, or power source ratings. For the outdoor cameras that feature built-in heaters, the operating temperature range is -40 to 60°C (-40 to 140°F).

- **Moisture:** Do not expose the camera to rain or moisture or try to operate it in wet areas. Turn the power off immediately if the camera is wet and ask a qualified service person for servicing. Moisture can damage the camera and also create the danger of electric shock.
- **Servicing:** Do not attempt to service this camera yourself. Any attempt to dismantle or remove the covers from this product will invalidate the warranty and may also result in serious injury. Refer all servicing to qualified service personnel.
- **Cleaning:** Do not touch the sensor modules with fingers. If cleaning is necessary, use a clean cloth with some ethanol and wipe the camera gently. If the camera will not be used for an extended period of time, put on the lens cap to protect the sensors from dirt.

## Package contents

Check the package and contents for visible damage. If any components are damaged or missing, do not attempt to use the unit; contact the supplier immediately. If the unit is returned, it must be shipped back in its original packaging.

Package contents include the following:

Stainless steel outdoor box camera housing with 2MPX camera, lens, fan, heater

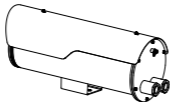

Installation guide



CD with configuration manual and  
TruVision Device Manager



Equipment disposal  
sheet



Battery disposal sheet



Hex wrench



Screw A (4 pcs.) with flat and split washers

Used to install the stainless steel outdoor housing onto the  
mount inside the stainless steel housing

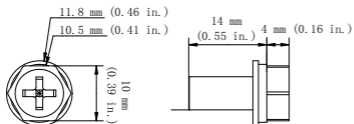

---

**CAUTION:** Use direct plug-in UL listed power supplies  
marked Class 2/CE certified or LPS (limited power source) of  
the required output rating as listed on the unit.

---



## SS box camera housing description

Figure 1: SS box camera housing description and connectors

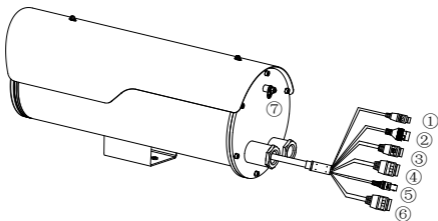

- |                       |                       |
|-----------------------|-----------------------|
| 1. RS-485             | 5. 960H analog output |
| 2. Ethernet RJ45 port | 6. Audio I/O          |
| 3. 24 VAC power cable | 7. Ground standoff    |
| 4. Alarm I/O          |                       |

## IR illuminators

The camera housing's built-in IR illumination provides high-quality video in low-light environments, even when there is no other illumination available.

The visible IR range may vary due to multiple factors such as weather, IR reflection level of objects in frame, lens adjustment, and camera settings. Please refer to the SS box camera housing datasheet for the standard IR range.

**Note:** Avoid installing the IR camera in close proximity to a solid object such as a tree or wall. The reflection will cause over-exposure and loss of visibility of detail in the field of view.

## Alarm input and output connections

The alarm output can be used to turn on and off an external alarm device. Connect a 30 VDC/1A external power supply to the alarm output. If using an AC power supply, an external relay must be used to prevent electric shock and damage to the device. See Figure 2 below.

Figure 2: External alarm output

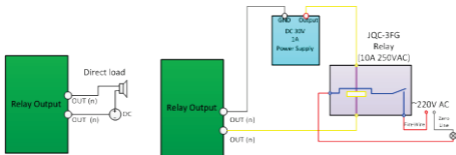

## SD memory card installation

### To install the SD memory card in the box camera

**Note:** You may be able to access the SD card slot without removing the box camera assembly from the housing. Remove the back cover by loosening the six hex screws using the hex wrench provided. The SD card slot is visible on the back of the box camera. Install the SD card into the SD card slot. See step 3 below.

1. Loosen the six hex screws (shown below) on the front cover and the six hex screws on the rear cover of the anti-corrosion housing using the supplied wrench.

**Note:** When removing the front cover, disconnect the IR illuminator cable harness.

- Remove the two Phillips head screws located at each end of the metal box camera bracket.

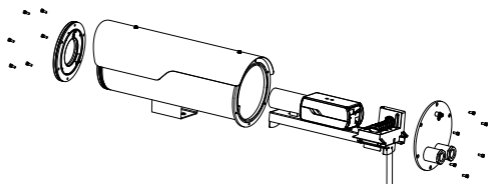

Phillips head screws

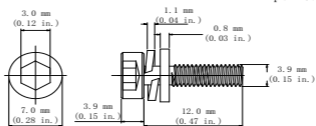

**Note:** When removing the box camera assembly from the housing, carefully lift and pull the assembly out towards the back of the housing.

- Insert the SD card into slot on the back of the box camera.

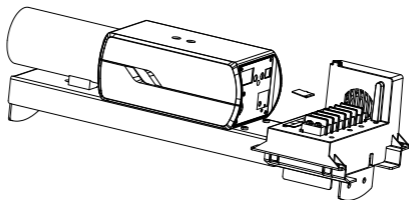

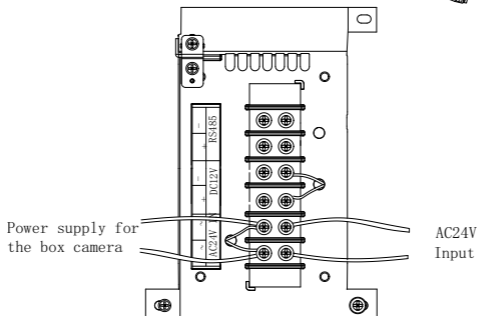
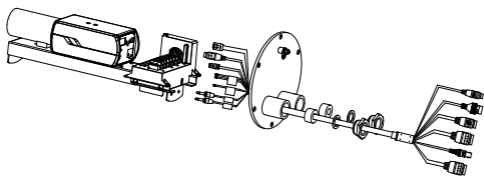

4. Reinstall the box camera assembly in the stainless steel housing..

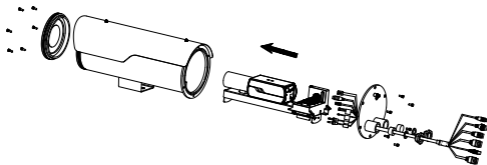

**Note:** When re-installing the box camera assembly in the housing, route the IR cable harness towards the front

cover opening. Plug the IR cable assembly back into the IR connector on the front lens cover plate. When reinstalling the front lens cover plate, position the IR sensor towards the top of the housing. Make sure that the black rubber gasket is in place.

5. Complete the assembly of the housing.

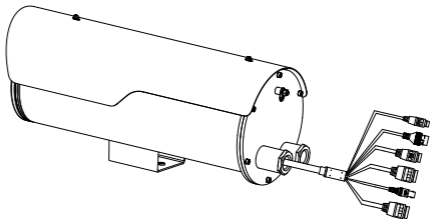

## Mounting the SS box camera housing

The TruVision SS Box Camera Housing Wall Mount (TVB-WBS, not included) is required to wall mount the SS box camera housing.

Refer to the installation guide provided with the TVB-WBS mounting kit for instructions on mounting the SS box camera housing to the wall.

## Mounting the TVJ-JBS junction box

Refer to the installation guide provided with the TVJ-JBS stainless steel junction box for instructions on mounting the SS box camera housing in conjunction with the TVJ-JBS junction box.

## Using the camera with an Interlogix NVR or Hybrid DVR or another system

Please refer to the NVR/DVR user manuals for instructions on connecting and operating the camera with these systems.

## Using the camera with TruVision Navigator

The camera can be connected to an Interlogix NVR, hybrid DVR, or directly to TruVision Navigator. Please refer to the user manual of TruVision Navigator and/or of the NVR or hybrid DVR for instructions.

## Access the camera over the internet

Use the web browser to access and control the camera over the internet.

**Note:** Any changes made to the camera's configuration only apply to this camera. Only authorized users should be able to modify camera settings.

When you first start up the camera, the Activation window appears. You must define a high-security admin password before accessing the camera. There is no default password provided.

You can activate a password via a web browser and via TruVision Device Manager (included on the CD to find the IP address of the camera).

## To activate the camera via the web browser:

1. Power on the camera and connect the camera to the network.
2. Type the IP address into the address bar of the web browser and press Enter to enter the activation interface.

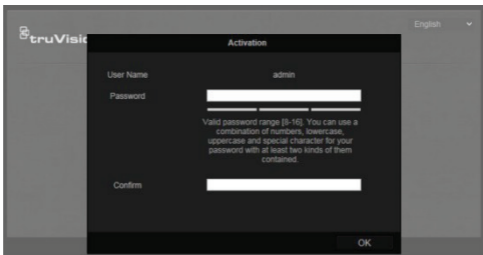

### Note:

- The default IP address of the camera is 192.168.1.70.
  - For the camera to enable DHCP by default, you must activate the camera via TruVision Device Manager. Please refer to the following section, “To activate the camera via TruVision Device Manager.”
3. Type the password in the **Password** field.

**Note:** A valid password range must be between 8 and 16 characters. You can use a combination of numbers, lower and upper case letters, and special characters : \_ - , . \* & @ / \$ ? Space. The password must contain characters from at least two of these groups. We also recommend that you reset your password regularly. For high security

systems, it is particularly recommended to reset the password monthly or weekly for better protection.

4. Confirm the password.
5. Click **OK** to save the password and enter the live view interface.
6. Click the **Configuration** tab on the top of the screen and select the parameter to change.

**Figure 3: Example of a configuration window**

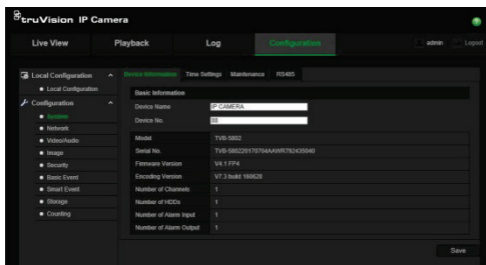

### To activate the camera via TruVision Device Manager:

For instructions on how to activate the camera using TruVision Device Manager, refer to the *TruVision Device Manager User Manual*. Go to [www.interlogix.com/video/product/truvision-device-manager](http://www.interlogix.com/video/product/truvision-device-manager) and click **Downloads**.



# Specifications

---

## Electrical

---

Voltage input 24 VAC

---

Power consumption Max. 100 W

---

## Miscellaneous

---

Connectors Audio In/Out, Alarm In/Out, 24 VAC Power, 960H Analog Output, RS-485, Ethernet RJ45

---

Operating temperature -40 to +60°C (-40 to +140°F)

---

Dimensions 465 × 189.7 × 180 mm  
(18.3 × 7.5 × 7.1 in.)

---

Weight 10.1 kg (22.3 lb.)

---

Environmental rating IP67

---

# Pin definitions

There are eight wires on a standard UTP/STP cable and each wire is color-coded. The following shows the pin allocation and color of straight and crossover cable connection:

**Figure 4: Straight-through cable**



**Figure 5: Cross-over cable**

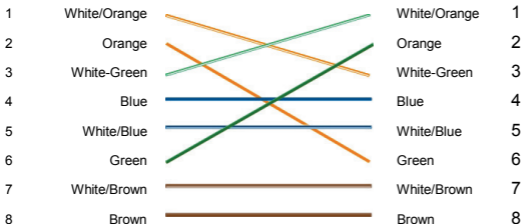

Please make sure your connected cables have the same pin assignment and color as above before deploying the cables in your network.



